

**NOTES:**

- (1) INLET/ OUTLET, ARE AVAILABLE IN IMPERIAL, METRIC OD-ID SLIP JOINTS, NPT PIPE AND ANSI FLANGES. (SPECIFIED BY PURCHASER)  
\* OTHER CONFIGURATIONS AVAILABLE UPON REQUEST
- (2) 1/4" , 3/8" , 1/2" NPT TEST PORTS.
- (3) LIFT EYES WILL BE ADDED ACCORDING TO LIFT POSITION (VERTICAL/HORIZONTAL)
- (4) FINISH: FLAT BLACK

REVISIONS				
ZONE	REV.	DESCRIPTION	DATE	APPROVED

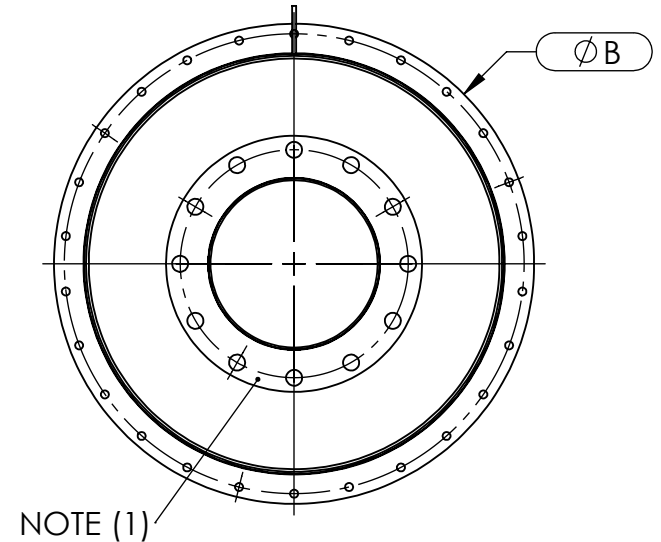
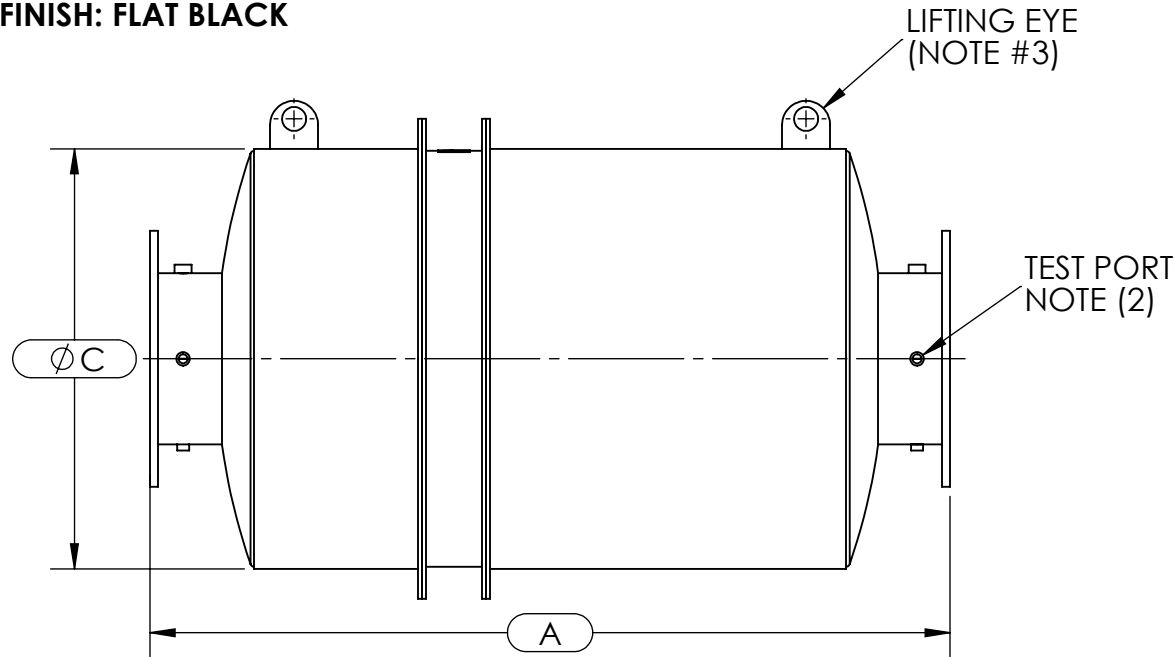

MODEL	MAX ENGINE POWER		MAX EXHAUST FLOW		DIMENSIONS			TOTAL WEIGHT (kgs)
	HP	KW	ACFM	M3/MIN	A	B	C	
18SXT-F	850	634	6000	170	38.0"	21.0"	18.0"	85
20SXT-F	1000	746	7500	213	42.0"	23.0"	20.0"	105
22SXT-F	1300	970	9000	255	44.0"	25.0"	22.0"	137
24SXT-F	1500	1119	10750	305	48.0"	28.0"	24.0"	177
26SXT-F	1600	1343	12600	357	50.0"	30.0"	26.0"	222
28SXT-F	2100	1567	14600	414	52.0"	32.0"	28.0"	271
30SXT-F	2400	1791	16800	476	54.0"	34.0"	30.0"	327
32SXT-F	2700	2015	19000	539	60.0"	35.5"	32.0"	367
34SXT-F	3000	2238	21500	610	64.0"	37.5"	34.0"	410
36SXT-F	3500	2611	24000	680	70.0"	39.5"	36.0"	457

**CATALYTIC EXHAUST PRODUCTS LIMITED**  
 30 INTERMODEL DR. # 19-22, BRAMPTON, ON  
 TEL: (905)-799-9770 FAX: (905)-799-9771

TOLERANCES ARE AS FOLLOWS UNLESS NOTED OTHERWISE  
 1 DEC PLACE ±.015  
 2 DEC PLACES ±.010  
 3 DEC PLACES ±.005

**MODEL 18SXT-F TO 36SXT-F**  
**DIMENSIONAL DETAILS**

DRAWN BY: Jose C. **B** DWG. NO. 18SXT-F - 36SXT-F REV

ISSUED: 25/03/2014 SCALE: N/A WEIGHT: SHEET 1 OF 1